



# Basket bag pattern

Pattern # tppatbasket



## Finished dimensions

- Approximately 13" (33cm) wide at top, 8" (20.4cm) wide at bottom x 6" (15.3cm) high x 5" (12.7cm) deep, handles and handle tab 6" (15.3cm) high

## You will need

- One hb1 Horse shoe bamboo handle and 4 x pf3 10mm purse feet (as shown below)



horse shoe bamboo handles # hb1



10mm purse feet # pf3

- Outer fabric: 9½" (24.2cm) long x 15" (38.2cm) wide OR 19" (48.4cm) long x 7½" (19.1cm) wide
- Lining fabric: Size as above
- Interfacing (for a structured basket bag): Size as above

Above supplies available from Tall Poppy Craft Products :: [www.tallpoppycraft.com](http://www.tallpoppycraft.com)

## PLUS:

- Thread to match fabric

# Instructions

## Step 1

Cut pattern pieces out and cut fabric as shown on pattern pieces. Transfer notches and markings from pattern pieces onto fabric pieces. Apply interfacing to outer sections.

## Note

When using iron on / fusible interfacing, ensure that a medium heat is applied to the interfacing. Often when the iron is too hot bubbles will form, causing the fabric to look creased.

## Step 2

Outer: Pin the right sides together and sew from Point A to B, D to E and G to H (Fig 1).

## Step 3

Make the corners by pulling the purse apart at Point C and bring Point B and D together so that a straight line forms. Make sure the raw edge is even. Pin. Sew along this straight line (Fig 2). Do the same for the opposite corner at Point F.

## Step 4

Turn the outer section right side out and iron out any wrinkles using a medium heat.

## Step 5

Insert purse feet on the purse feet placement markers as shown on the pattern (Fig 3).

## Note

Please go to our tutorials section at: <http://www.tallpoppycraft.com/catalog/tutorials.php> if you need guidance on how to install our purse feet.

## Step 6

Lining: Pin the right sides together and sew from Point A to B, D to E and G to H. Make sure to leave a gap in the sewing between the two notches (this is where we will turn the purse right side out in Step 10) (Fig 4).

## Step 7

Repeat Step 3 to make the corners for the lining section.

## Step 8

Tabs: Fold the left hand side (the long side) into the center of the tab. Fold the right hand side (the long side) into the center of the tab. The two long sides should meet half way. Press. Fold in half a second time so that the raw edge is now tucked inside the tab. Press, pin and sew down each long side, leaving the raw edges on the bottom and top edges open (Fig 5).

## Step 9

Turn the outer section right side out. Fold tabs in half so that the top and bottom raw edges are together. A loop should now be formed. Pin the tabs to the outer section where shown on the handle tab placement markers on the pattern. Make sure that the raw edges of the handle tabs and the raw edge of the top of the purse are even. Secure the tabs by stay-stitching them in place (Fig 6).

## Step 10

With the lining turned inside out, place the outer section (which is now turned right side out) inside the lining. The right sides of both the lining section and the outer section should now be together and the wrong side of the lining should be facing you.

## Step 11

Ensure that the raw edge of the top of the outer section and the raw edge of the top of the lining section is matched evenly. The handle tabs should be sandwiched between the outer and lining and the tabs should be pointing down to the ground (not sticking out of the top). Pin around the top of the purse and sew right around the circumference of the top of the purse (Fig 7).

## Step 12

Pull the outer section right side out through the hole in the lining. Push the lining inside and press the purse to iron out any wrinkles. Top stitch along the circumference of the top of the purse (Fig 8). Sew up the hole in the lining and push the lining back inside the purse.

## Step 13

Attaching handles: Remove the silver D-rings from the bamboo handles (use a size 1 screw driver). Insert the D-ring through the handle tab loop. Place the bamboo handle inside the D-ring, screw in the D-ring (Fig 9).

## Step 14

Repeat Step 13 for remaining 3 D-rings.



Fig 1

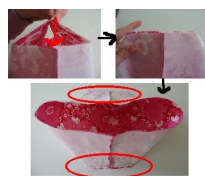

Fig 2



Fig 3



Fig 4

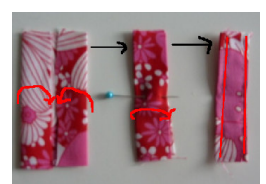

Fig 5



Fig 6



Fig 7



Fig 8

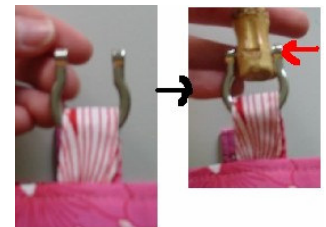

Fig 9

Note: As there are 2 pattern pieces contained on this page, print page twice.

